



FRONTAGE SETBACK ALONG LOUISE AVE
 PROPERTY LENGTH; 369'
 LENGTH OF FACADE WITH MIN/MAX SETBACK: 236'-2"
 FRONTAGE PERCENT WITHIN MIN/MAX SETBACKS: 64%
 FRONTAGE PERCENTAGE OUTSIDE MIN/MAX SETBACK: 36%
 LENGTH OF FACADE OUTSIDE MIN/MAX SETBACK: 132'-10"

LEGEND

 AREA WITHIN MILL CREEK FLOODPLAIN

 PROPERTY LINE

AT THIS CORNER, FLOOD MODEL RECEIVED FROM CITY OF DALLAS SHOWS 5.7' OF FLOODING DURING 100-YEAR STORM, THEREFORE BUILDING DESIGNED TO BE OVER 6'-0" ABOVE ADJACENT SIDEWALK.

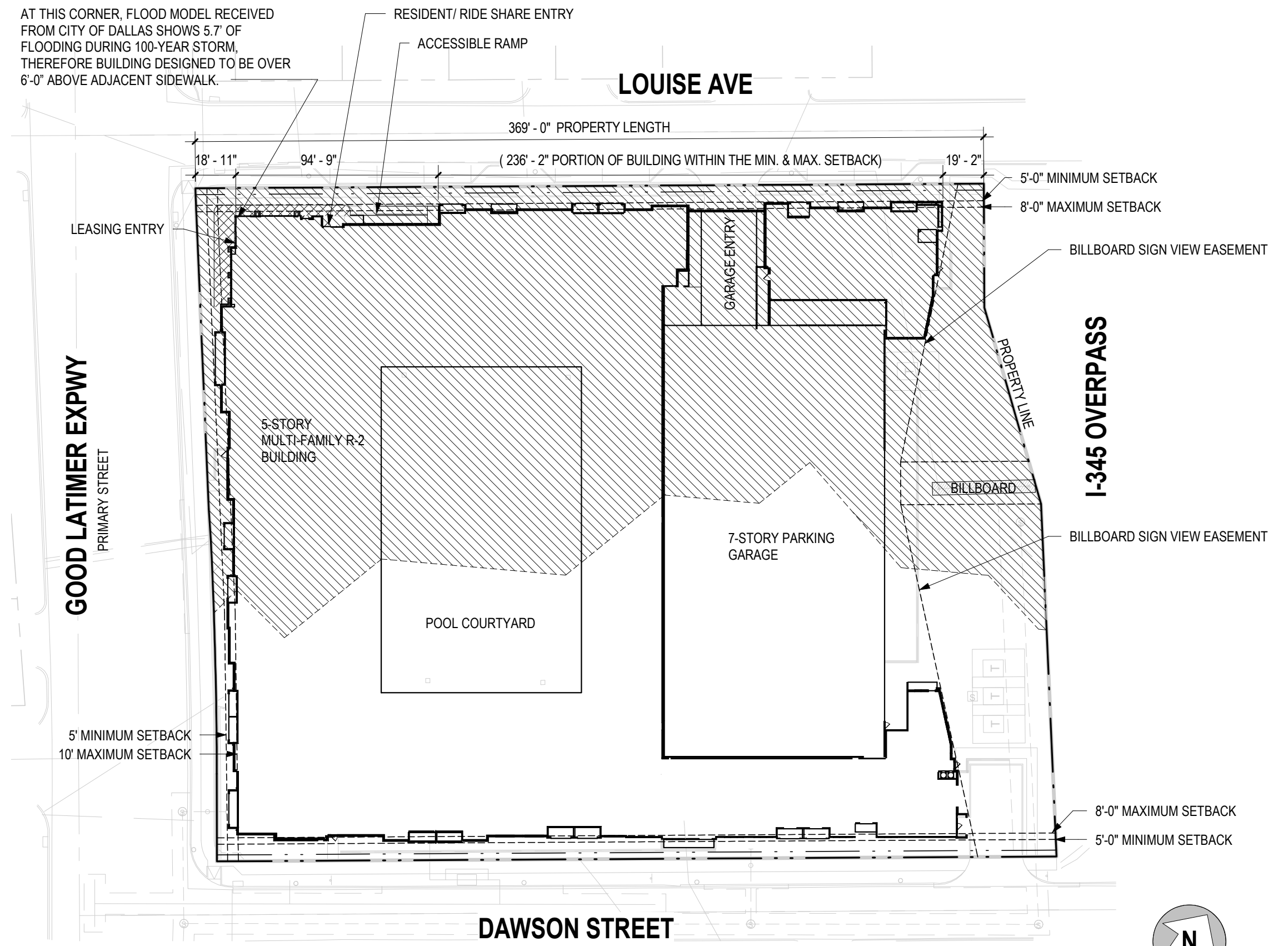

ZONING
 PD 317 - SUB DISTRICT 4
 M212-048